

REVISIONS			
REV.	DESCRIPTION	DATE	APPROVED
REL-01		7/30/2007	
REL-02		10/8/2007	P.J.W.
REL-03	Changed From 42" by 42"	7/8/2008	M.F.K.

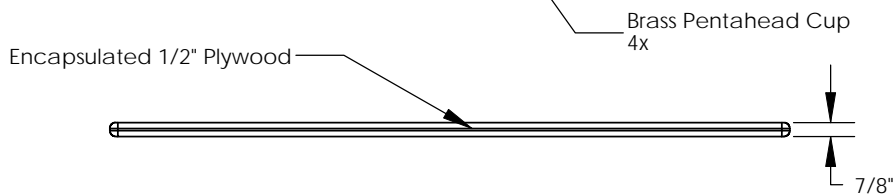
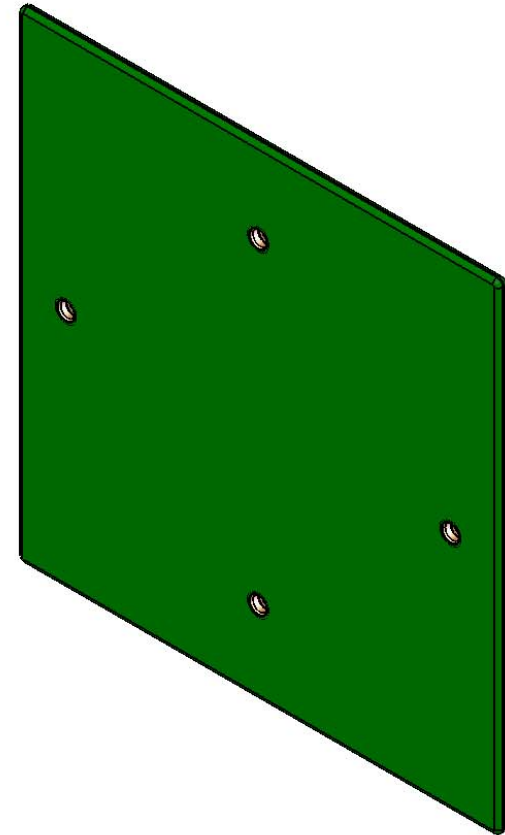
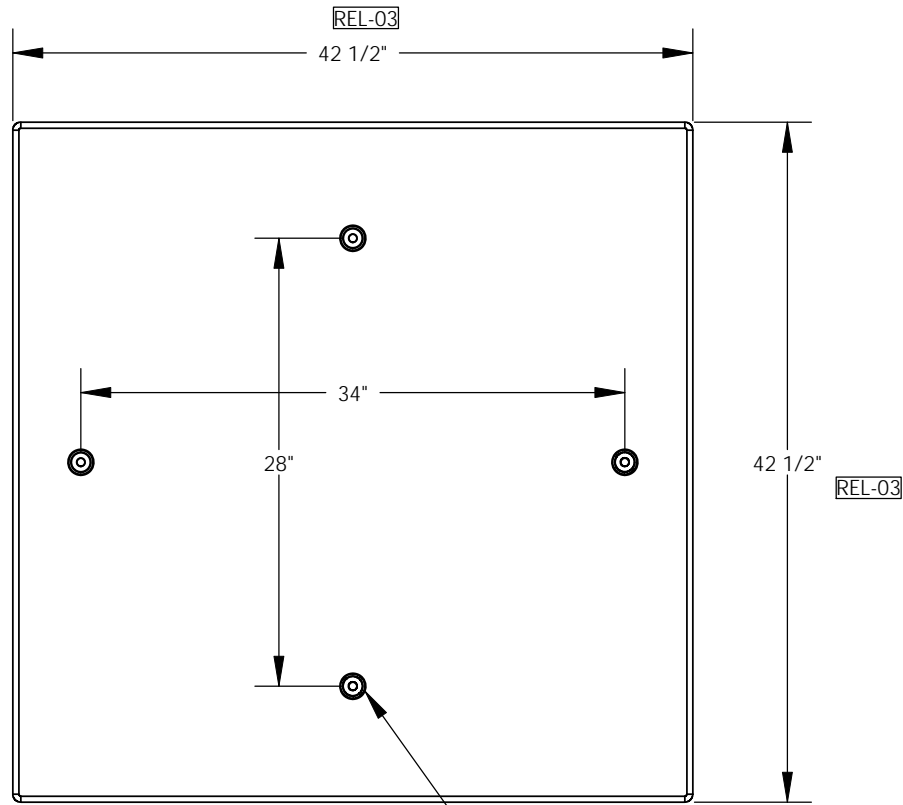

NOTE:
Includes (4) 3/8-16x1.5 SST
Pentahead Bolts

PROPRIETARY AND CONFIDENTIAL
THE INFORMATION CONTAINED IN THIS DRAWING IS THE SOLE PROPERTY OF NORDIC FIBERGLASS, INC. ANY REPRODUCTION IN PART OR AS A WHOLE WITHOUT THE WRITTEN PERMISSION OF NORDIC FIBERGLASS, INC. IS PROHIBITED.

Customer Name: N/A		
DIMENSIONS ARE IN INCHES		
TOLERANCES: ANGLES ± 1°		
FRACTIONAL ± 1/32		
ONE PLACE DECIMAL ±.060		
TWO PLACE DECIMAL ±.030		
THREE PLACE DECIMAL ±.015		
MATERIAL		
	NAME	DATE
DRAWN	P.J.W.	07/30/07
CHECKED	---	--/--

Nordic Fiberglass, Inc.		
21415 US Hwy 75 NW, Warren, MN 56762		
www.nordicfiberglass.com		
218-745-5095 ph. --- 218-745-4990 fax		
GSC-42-42-MG		
SIZE	ITEM ID:	REV.
A	02140.00	REL-03
SCALE:1:12	SHEET 1 OF 1	